

# Remote Fan Air Flow Meter w/RH%



## Handheld Anemometer w/RH% 8902/8911/8912

- ▲ Remote fan with built-in temp.&humidity sensor
- ▲ Measures air velocity , temperature, humidity, air volume, dew point& wet bulb temperature
- ▲ Patent design rotation sensor cap to protect sensors
- ▲ Windspeed metric and imperial units selectable
- ▲ Temp. Units °C/°F selectable
- ▲ Display max. /min. value
- ▲ Hold function to freeze current readings
- ▲ Auto power off in 15 mins inactivity to save power
- ▲ Sleep and non-sleep mode selectable
- ▲ Tripod mountable receptacle
- ▲ Backlight function to use in dark area
- ▲ Low battery indicator
- ▲ 8911 extra features: PC link, 8 points velocity average
- ▲ 8912 extra features: PC link, BTU capacity calculation

### What is BTU?

A BTU, short for British Thermal Unit, is a basic measure of thermal (heat) energy. One BTU is the amount of energy needed to heat one pound of water one degree Fahrenheit, measured at its heaviest point.

In other words, if you placed 16 ounces of water at 59°F into a stovetop pan and turned on the gas burner, it would take one BTU to raise the temperature of the water to 60°F.

As more BTUs continue to flow from the gas flame, the water will eventually reach the boiling point of 212°F.

### Optional



#### REPLACEMENT VANE PROBE

P/N:VY891PAZ

FOR MODELS 8902 , 8911 , 8912

UNIQUE ROTATE PROTECTIVE CAP

TO PREVENT DUST DAMAGE

REMOTE PROBE WITH BUILT-IN

TEMP.&HUMIDITY SENSOR.

FAN SIZE: 75mmDia x 170mm H

CABLE LENGTH: 50cm (extended to 1.5M)

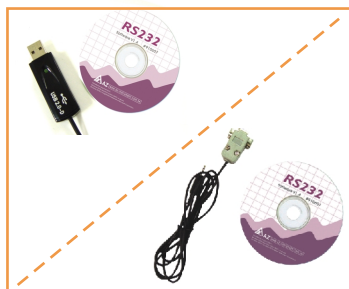

#### USB cable & software

P/N: VZUSBAZM

#### RS232 cable & software

P/N: VZRS232NB

|                           | 8902   | 8911 | 8912 |
|---------------------------|--|------|------|
| Wind speed range          | 0.6~32M/S  |      |      |
| Wind speed accuracy       | +/- (2 % of reading +0.2 m/s)                    |      |      |
| Air temp. range           | -20.0~60.0°C                                     |      |      |
| Air temp. resolution      | 0.1°C/°F   |      |      |
| Air temp. accuracy        | +/-0.6°C   |      |      |
| Air RH% range             | 0%RH~100%RH                                      |      |      |
| Air RH% resolution        | 0.1%RH   |      |      |
| Air RH% accuracy          | +/-3%RH(at 25°C, 10~90%RH, others +/-5%RH)       |      |      |
| Temp. response time       | 60 seconds (typical)                             |      |      |
| Air RH% response time     | 60 seconds (typical)                             |      |      |
| LCD update                | every second                                     |      |      |
| Wet Bulb temp. display    | -22~70.0°C                                       |      |      |
| Dew point temp.display    | -68~70.0°C                                       |      |      |
| Air volume display        | 0 to 99999m <sup>3</sup> /minute                 |      |      |
| Air volume resolution     | 0.1(0 to 9999.9) or 1 (10000 to 99999)           |      |      |
| LCD size                  | 26(H)x44(W)mm                                    |      |      |
| Operating temp.           | 0~50°C   |      |      |
| Operating RH%             | Humidity<80%                                     |      |      |
| Storage temp.             | -10~50°C   |      |      |
| Storage RH%               | Humidity < 90%                                   |      |      |
| PC Link                   | N/A  | YES  | YES  |
| 8 points velocity average | N/A  | YES  | N/A  |
| BTU capacity              | N/A  | N/A  | YES  |
| Dimension(mm)             | 175x70x33 (meter);170x77x40 (vane)               |      |      |
| Weight                    | ~170g  |      |      |
| Battery                   | AAA x 4pcs or 9VDC adappor                       |      |      |
| Optional accessory        | Software kit / replacement vane                  |      |      |
| Standard Package          | Meter/Vane probe/Battery/Manual/ Hard carry case |      |      |